

GMA 345/342 Quick Reference Card

GMA 345/342 Alternate Key Functions (GMA 342 example displayed)



Press and Hold
Either:
Monitor Mute

Press and Hold:
Radio Mute
Music

Press and Hold:
Passenger Mute

Press and Hold:
Intercom Mute
Music

Press and Hold:
Marker Beacon
Hi Sense

Press
Simultaneously:
Split COM

Press and Hold:
Passenger Address

Press
Simultaneously:
Music EQ

Press
Simultaneously:
Bass Boost

Press and Hold:
3D Audio

1) Disabled
2) Classical
3) Pop
4) Rock

1) Disabled
2) Medium
3) High

GMA 345 Bluetooth Functions

Press Simultaneously:
Bluetooth Media - Play/Pause

Press Simultaneously:
Bluetooth Media - Skip Previous

Press Simultaneously:
Bluetooth Media - Skip Next

Press and Hold:
Bluetooth Pairing Mode

Press Simultaneously:
Bluetooth Recording Mode

Press and Hold:
Decrease Bluetooth Phone Volume

Press and Hold:
Increase Bluetooth Phone Volume

GMA 345 Bluetooth Features

To pair a Bluetooth device to the GMA 345:

- 1) Press and hold the **TEL (PAIR)** key for one second.
- 2) The GMA 345's Bluetooth annunciator flashes blue and the aural message "Pairing Enabled" is heard. The GMA 345 is discoverable for two minutes.
- 3) Use another Bluetooth device to scan for the GMA 345 and pair with it.
- 4) The GMA 345's Bluetooth annunciator changes to steady blue.

The GMA 345 will automatically reconnect to the last connected device when it's nearby. While a device is connected, the Bluetooth annunciator will illuminate steady blue. Otherwise the Bluetooth annunciator will be unlit.

BLUETOOTH TELEPHONE CALLS

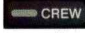
- When a phone is receiving a phone call, the **TEL** key will flash blue.
- To answer the call, press the **TEL** key.
- To make a call using the GMA 345, press the **TEL** key first, then dial and send the call using the connected phone.
- While a call is active, press and hold the **PILOT** key  to increase call volume, and press and hold the **CREW** key  to decrease call volume.
- To disconnect an active call, press the **TEL** key again. When a call is disconnected, the **TEL** key returns to its previous state.

ENABLE RECORDER OUTPUT FOR ACTION CAMERAS

First pair the action camera with the GMA 345 using the instructions listed previously. For Garmin action cameras, such as a Virb Ultra, setup is now complete.

Third-party non-Garmin action cameras (that support Bluetooth microphone audio) require Recording Mode to be manually enabled. Once paired, enable Recording Mode on the GMA 345 by pressing the **TEL** and **PILOT** keys simultaneously. The aural message "Bluetooth Recording Mode Enabled" is heard.

GMA 345 USB Jack

The USB power jack is a Type A jack that will charge any device while the GMA is powered on. It supports a maximum of 2.1 amps charge current to devices. The USB power jack will turn off if aircraft power falls below 11 volts. The included USB jack dust cover can be clipped to a USB cable for safekeeping.

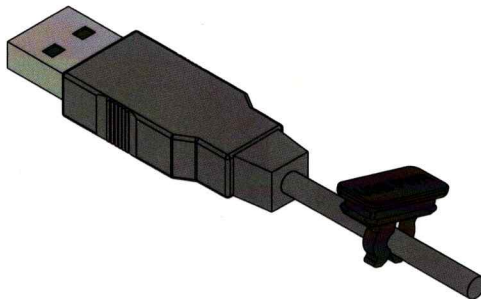

USB Jack Dust Cover Clipped to USB Cable